



wards
Residential

7 Praetor House, Upper Bond Street, Hinckley, LE10 1RP
£137,500

Leasehold

Leasehold. 127 years remaining. Wards are delighted to present this well presented second floor apartment with allocated parking on the outskirts of Hinckley town centre. The apartment is to the highest standard and comprises an entrance lobby, hall, a spacious lounge, fitted kitchen two bedrooms and bathroom. UPVC double glazing and gas central heating

Kitchen

Fitted with wooden wall and base units, laminate work surfaces, gas hob, oven, sink and drainer, tiled splash backs, tiled flooring, plumbing for washing machine and UPVC double glazed window to the front elevation.

Lounge

With four UPVC double glazed windows to the front elevation.



Bathroom

Fitted with a four-piece white suite including a low flush WC, sink on vanity, shower over bath, tiled floor, tiled splash backs, ceiling spotlights and an extractor fan.

Bed 1

With UPVC double glazed window to the rear elevation.

Bed 2

With UPVC double glazed window to the rear elevation.

Bathroom

Fitted with a four-piece white suite including a low flush WC, sink on vanity, shower over bath, tiled floor, tiled splash backs, ceiling spotlights and an extractor fan.

Council Tax Band - B

Call 01455 251771 to make an appointment to view this property



GROUND FLOOR
567 sq.ft. (52.7 sq.m.) approx.

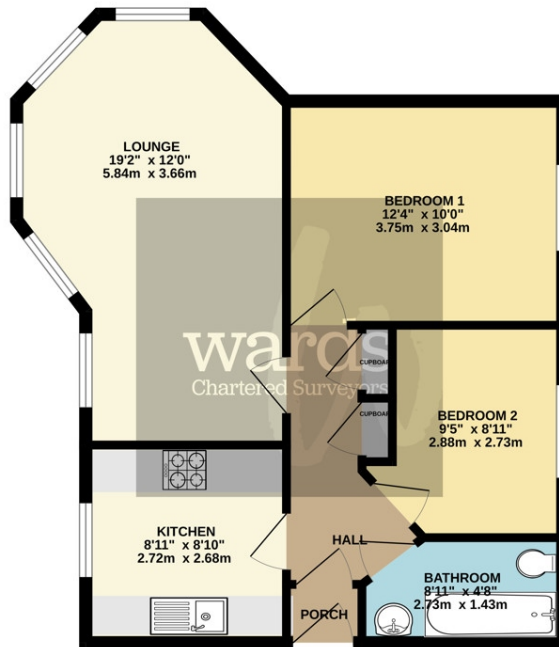

TOTAL FLOOR AREA : 567 sq.ft. (52.7 sq.m.) approx.
Whilst every attempt has been made to ensure the accuracy of the floorplan contained here, measurements of doors, windows, rooms and any other items are approximate and no responsibility is taken for any error, omission or mis-statement. This plan is for illustrative purposes only and should be used as such by any prospective purchaser. The services, systems and appliances shown have not been tested and no guarantee as to their operability or efficiency can be given.
Made with Metropack (2022)

These particulars, whilst intended & believed to be accurate are set out as a general outline only and do not constitute any part of an offer or contract. Intending purchasers should not rely on them as statements of representation of fact, but must satisfy themselves by inspection or otherwise as to their accuracy. No person in this firm's employment has the authority to make or give any representation or warranty in respect of the property.



20 Station Road
Hinckley Leicestershire LE10 1AW

01455 251771
info@wardsonline.co.uk

wardsonline.co.uk



Ward Surveyors Limited - Registered in England No.4567836